

Formulate Essential Square Hanging Structures

ESS-SQU

Formulate™ Essential Square tension fabric hanging structures are available in numerous sizes. The economy aluminum tube frame features bungee cords and push button connectors for easy connections, hanging cables and a zippered pillowcase graphic. All sizes come with a carry bag and feature a one year limited hardware warranty.



Single sided graphic

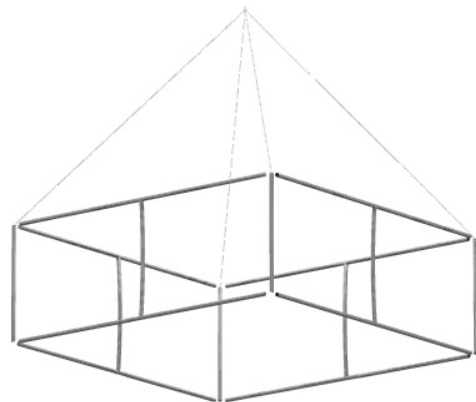

Frame



Double sided graphic



Graphic with printed bottom

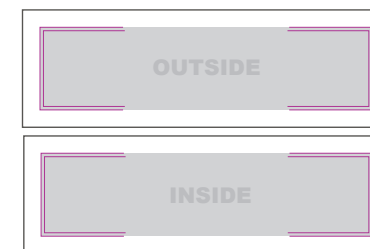
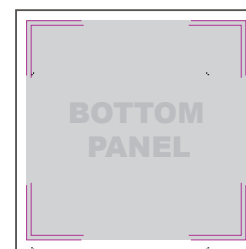
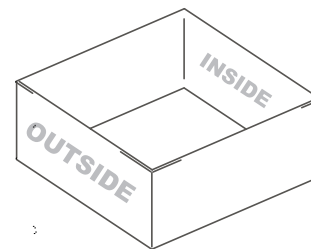

features and benefits:

- Economy aluminum tube frame features bungee cords and push button connectors
- Quick set up
- Graphics available double or single sided
- Kit Includes: one frame, pillowcase zipper fabric graphic (sold separately), hanging cables and carry bag
- One year limited hardware warranty against manufacturer defects

dimensions:

Hardware	Shipping
Hardware dimensions can be found on page 2	<p>Shipping dimensions:</p> <p>0802: 54"l x 14"w x 9"h 1372mm(l) x 356mm(w) x 229mm(h)</p> <p>0803: 54"l x 14"w x 9"h 1372mm(l) x 356mm(l) x 229mm(h)</p> <p>0804: 54"l x 14"w x 9"h 1372mm(l) x 356mm(w) x 229mm(h)</p> <p>1002: 65"l x 14"w x 9"h 1321mm(l) x 356mm(w) x 229mm(h)</p> <p>1003: 65"l x 14"w x 9"h 1321mm(l) x 356mm(w) x 229mm(h)</p> <p>1004: 65"l x 14"w x 9"h 1321mm(l) x 356mm(l) x 229mm(h)</p> <p>1202: 52"l x 14"w x 12"h 1575mm(l) x 356mm(w) x 305mm(h)</p> <p>1203: 52"l x 14"w x 12"h 1575mm(l) x 356mm(w) x 305mm(h)</p> <p>1204: 52"l x 14"w x 12"h 1575mm(l) x 356mm(w) x 305mm(h)</p> <p>Approximate shipping weight (includes hardware and carry bag only):</p> <p>0802: 29 lbs / 13.2 kgs</p> <p>0803: 32 lbs / 14.5 kgs</p> <p>0804: 35 lbs / 15.9 kgs</p> <p>1002: 33 lbs / 15 kgs</p> <p>1003: 36 lbs / 16.3 kgs</p> <p>1004: 39 lbs / 17.7 kgs</p> <p>1202: 39 lbs / 17.7 kgs</p> <p>1203: 42 lbs / 19.1 kgs</p> <p>1204: 45 lbs / 20.4 kgs</p>
Graphics	
Graphic dimensions can be found in the graphic templates, which can be viewed at www.exhibitors-handbook.com/graphic-templates	
Graphic Material: 5 oz. Soft Knit Dye-sublimated zipper pillowcase fabric	

We are continually improving and modifying our product range and reserve the right to vary the specifications without prior notice. All dimensions and weights quoted are approximate and we accept no responsibility for variance. E&OE. See Graphic Templates for graphic bleed specifications.

SQU-8' WIDTH							
HEIGHT	HARDWARE CODE	SINGLE-SIDED GRAPHIC CODE	OUTER GRAPHIC SPECS	DOUBLE-SIDED GRAPHIC CODE	INSIDE GRAPHIC SPECS	BOTTOM ZIP-IN PANEL (PRINTED) CODE	BOTTOM PANEL GRAPHIC SPECS
2'	SQU-0802	SQU-0802-G	96"W X 24"H	SQU-0802-GDBL	96"W X 24"H	SQU-0802-GPBP	96"W X 96"H
3'	SQU-0803	SQU-0803-G	96"W X 36"H	SQU-0803-GDBL	96"W X 36"H	SQU-0803-GPBP	96"W X 96"H
4'	SQU-0804	SQU-0804-G	96"W X 48"H	SQU-0804-GDBL	96"W X 48"H	SQU-0804-GPBP	96"W X 96"H



Single sided graphic

SQU-10' WIDTH							
HEIGHT	HARDWARE CODE	SINGLE-SIDED GRAPHIC CODE	OUTER GRAPHIC SPECS	DOUBLE-SIDED GRAPHIC CODE	INSIDE GRAPHIC SPECS	BOTTOM ZIP-IN PANEL (PRINTED) CODE	BOTTOM PANEL GRAPHIC SPECS
2'	SQU-1002	SQU-1002-G	120"W X 24"H	SQU-1002-GDBL	120"W X 24"H	SQU-1002-GPBP	120"W X 120"H
3'	SQU-1003	SQU-1003-G	120"W X 36"H	SQU-1003-GDBL	120"W X 36"H	SQU-1003-GPBP	120"W X 120"H
4'	SQU-1004	SQU-1004-G	120"W X 48"H	SQU-1004-GDBL	120"W X 48"H	SQU-1004-GPBP	120"W X 120"H



Double sided graphic

SQU-12' WIDTH							
HEIGHT	HARDWARE CODE	SINGLE-SIDED GRAPHIC CODE	OUTER GRAPHIC SPECS	DOUBLE-SIDED GRAPHIC CODE	INSIDE GRAPHIC SPECS	BOTTOM ZIP-IN PANEL (PRINTED) CODE	BOTTOM PANEL GRAPHIC SPECS
2'	SQU-1202	SQU-1202-G	144"W X 24"H	SQU-1202-GDBL	144"W X 24"H	SQU-1202-GPBP	144"W X 144"H
3'	SQU-1203	SQU-1203-G	144"W X 36"H	SQU-1203-GDBL	144"W X 36"H	SQU-1203-GPBP	144"W X 144"H
4'	SQU-1204	SQU-1204-G	144"W X 48"H	SQU-1204-GDBL	144"W X 48"H	SQU-1204-GPBP	144"W X 144"H



Printed zip-in bottom panel

SET UP INSTRUCTIONS:

STEP 1: TOP AND BOTTOM SHAPE ASSEMBLY

1. CONNECT ALL TUBES LINKED WITH A BUNGEE CORD.

2. CONNECT OPEN ENDED TUBES BY MATCHING NUMBERS (1 TO 1, 2 TO 2, ETC.).

STEP 2: SPREADER ATTACHMENT

1. CONNECT BOTTOM OF SPREADER TUBES TO BOTTOM SHAPE STRUCTURE WITH PUSH BUTTONS BY MATCHING LETTERS (A TO A, B TO B, ETC.).

2. CONNECT TOP OF SPREADER TUBES TO TOP SHAPE STRUCTURE WITH PUSH BUTTONS BY MATCHING LETTERS (A TO A, B TO B, ETC.).

STEP 3: GRAPHIC ATTACHMENT

1. SLIDE PILLOWCASE GRAPHIC ONTO FRAME.

2. ZIP GRAPHIC CLOSED ON THE TOP OF THE STRUCTURE.

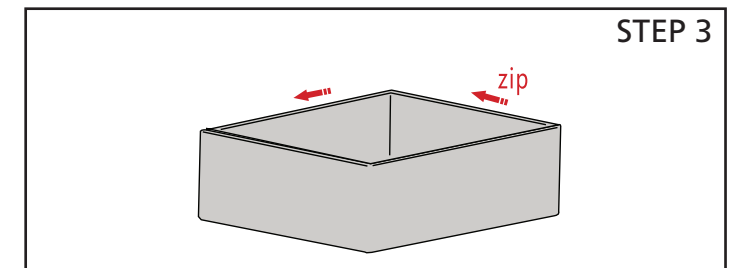
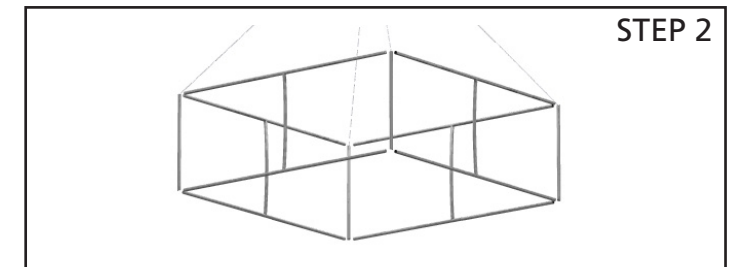
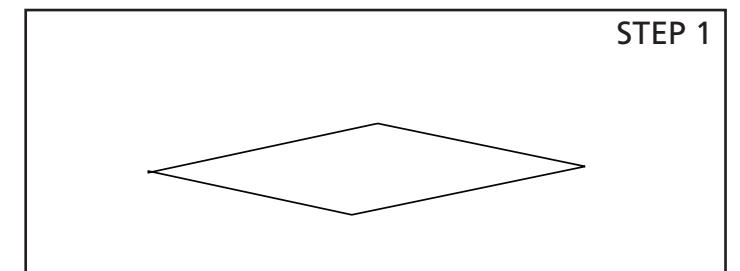
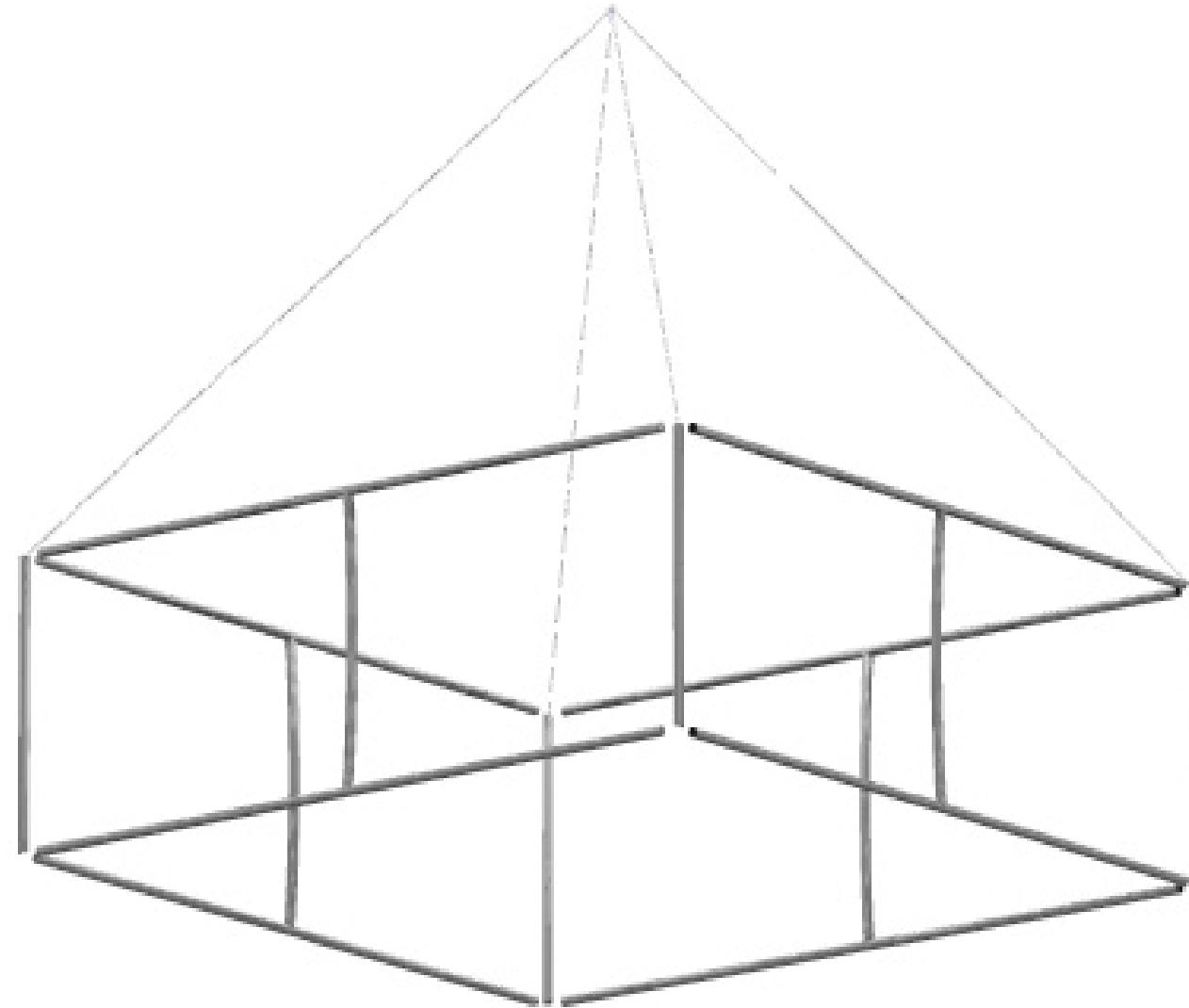

ESSENTIAL SQUARE- ALL SIZES

