

# Exhibitor Products (AlumaSlatwall)

1. Attach uprights using screws provided.
2. Insert front slatwall section into channel of uprights.
3. Install rear slatwall behind front slatwall.
4. Repeat installation process for additional slatwall sections.
5. Attach frame to uprights using the screws provided.
6. Insert Graphic at top of frame.

*NOTE: Model shown below may differ from your model. Although the number of upright sections may change, assembly instructions remain the same.*

## Applicable Products:

LUP11 (One-Sided Slatwall)  
LUP11H (One-Sided with Header)  
LUP12 (Two-Sided Slatwall)  
LUP12H (Two-Sided with Header)  
LUP22 (Two-Sided with 22" x 28" Frame)  
LUP22H (Same with Header)

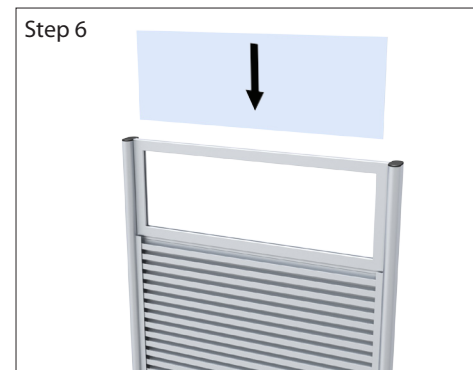
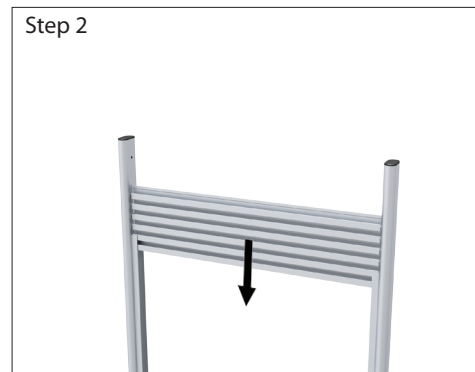

LUP12H shown