

Simple Standee™ - VEE Series

1. Fasten uprights to base using the screws provided.
2. Attach the crossbar to the uprights, from the outside in, using the screws provided.
3. Remove the backing protecting the adhesive from one side of the velcro strip pair (not shown), then stick the velcro strip pair to the upright. Repeat this step for the additional velcro strips.
4. Remove the protective backing from the other side of the velcro strip pairs (not shown), then carefully attach the graphic to the exposed adhesive of the velcro strip pairs mounted on the unit.
5. Repeat steps 3 and 4 for the rear graphic, if applicable (not shown).
6. The graphic may be removed from the unit by carefully separating the velcro strip pairs using your fingers.

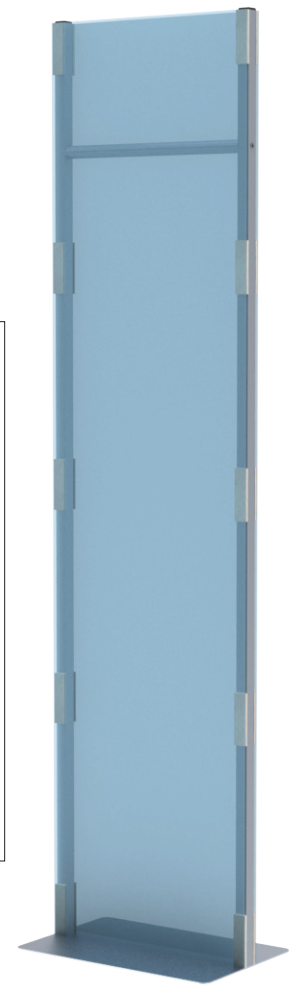
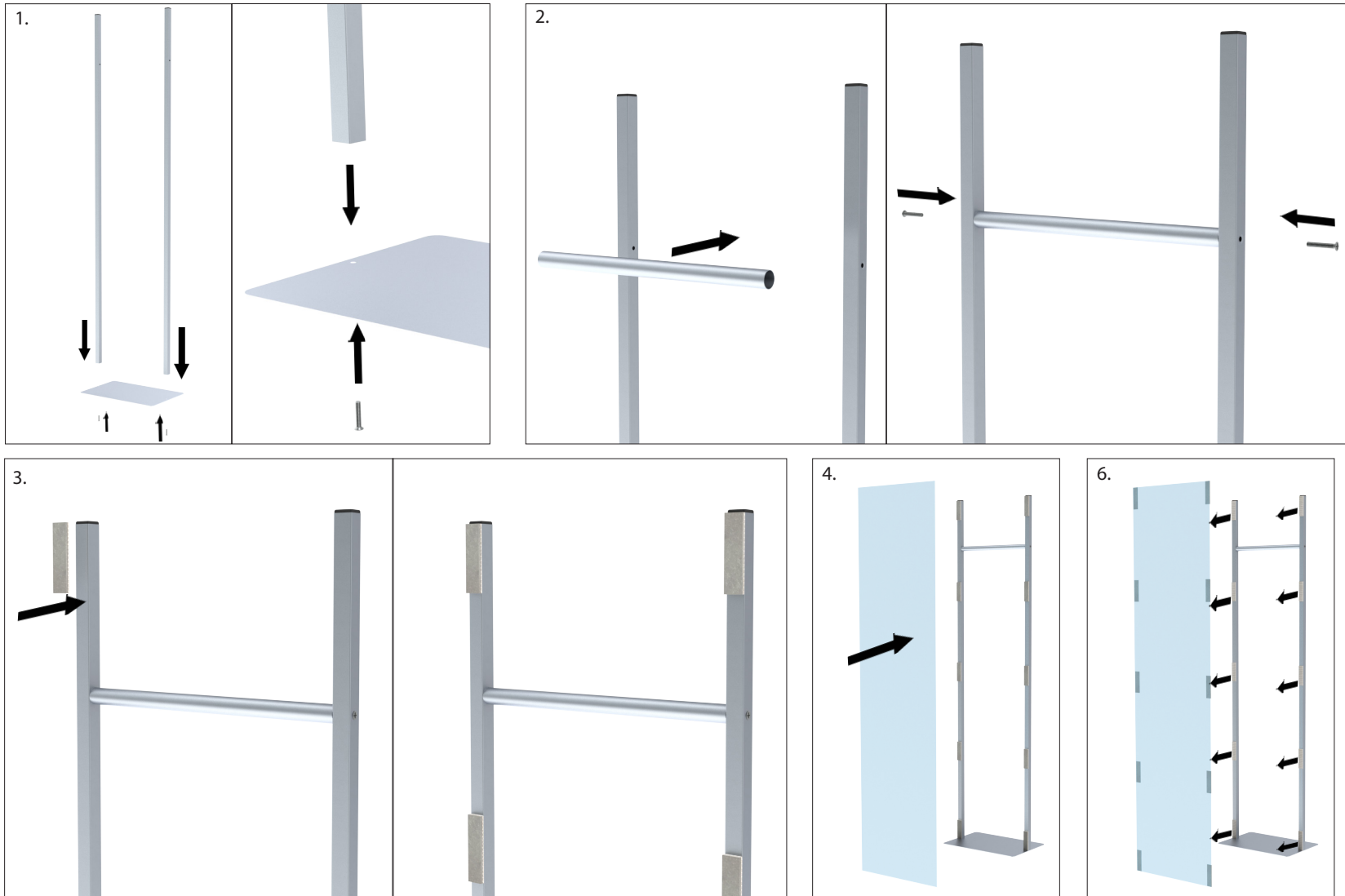

VEE618 shown