

# ASPEN SLIM WALL MOUNT INSTRUCTIONS



## Split Connector Installation\*

1. Slide split connector into interior channel of 1 profile and tighten screw with allen key
2. Slide opposite profile onto other end of split connector and tighten screw with allen key
3. Repeat process for all necessary sides of the frame.

\*Only used on tall/wide frames to connect long horizontal or vertical profiles



## Corner Connector Installation

1. Align front lock plate with back pressure plate back to back
2. Slide the aligned pieces into the channel of the extrusion
3. Slide the adjacent extrusion onto the corner connector
4. Tighten screws with allen key
5. Repeat process for all sides

You can use the bracket along the vertical or horizontal section located on the inside of the frame.

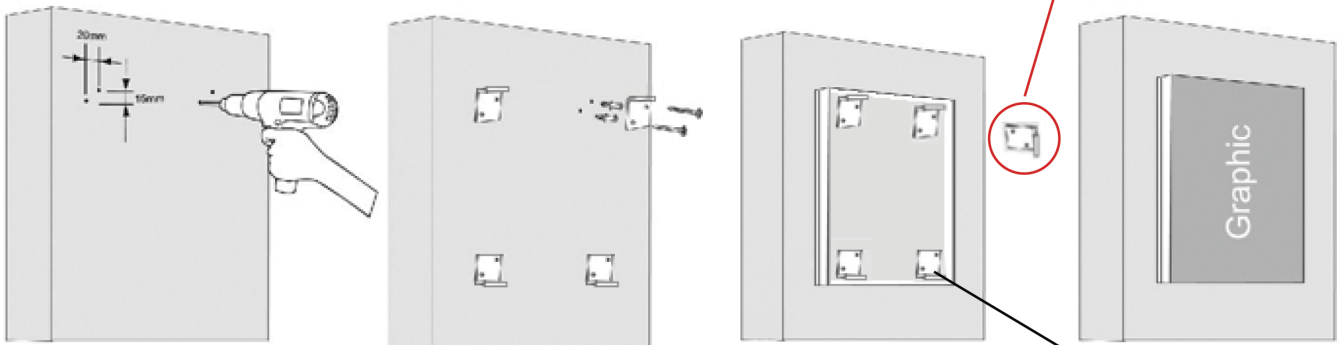

## Wall Mount Installation

1. Screw 4 wall mounts to wall close enough for the threaded screw to be able to apply pressure to the frame
2. Use an allen key and tighten each screw apply pressure along each side of the frame
3. Install graphic

