

Scan to view Product Instructional Video or visit:
<http://www.creativeDisplaysite.com/Xceptional.html>

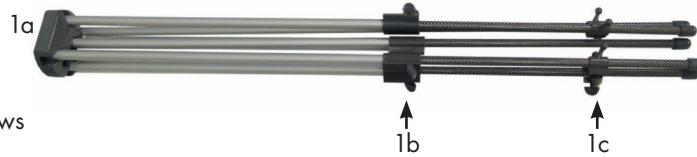

Product Parts

- 1 - X-Ceptional Banner Display
- 1a - Hub
- 1b - Arm Adjusting Screws
- 1c - Grommet Hook Adjusting Screws



Display Set-Up

Step 1

Take all parts out of the bag. Place the banner on a clean flat surface. Lift all Arms into place on the Hub (1a).



Step 3

Attach banner by inserting the hooks located on the Top into the top grommets of the banner. Gently pull the banner down to hook the lower banner grommets to the lower Hooked Arms (2).

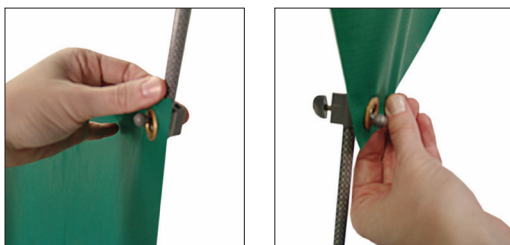

Step 2

Extend each arm to the Approximate length of your banner by loosening the Arm Adjusting Screws (1b) to pull the arm out and tightening to secure into place.

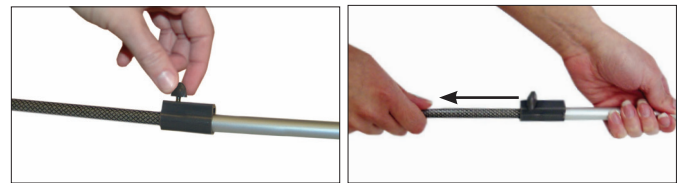

Step 4

You can adjust the tension on your banner further by the grommet hooks on the lower arms. Loosen the Grommet hook Adjusting Screws (1c) to slide them up or down, and tighten to secure into place.

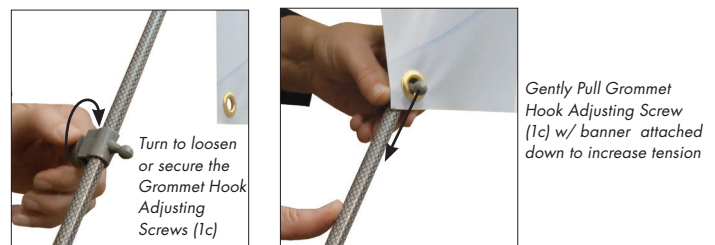

Note:

The X-Ceptional Banner Display is designed to bend and when properly installed, the Banner will pull taut and the Hooked Arms will arch. However, if a banner smaller than the recommended size is installed, it may cause permanent failure of the display.

Storage

Place all product parts into Carry Case and store in a cool dry location.



Care

To clean, wipe with damp cloth.