

ARCH -03

ARCH-03

Formulate™ Arches add architecture and design to any event or interior space! Easily create and define a stunning entryway, focal point or stage set at your next tradeshow or event. Formulate Arches combine pillowcase style stretch fabric graphics with 50mm curved aluminum tube frames; these super structures are made in the USA and collapse to a fraction of their size.



features and benefits:

- State-of-the-art 50mm curved aluminum tube frame with sturdy internal spigots
- Two monitor mounts included, externally facing, adding a bonus opportunity to display messaging and branding
- Kit includes: one frame, one dye-sublimated zipper pillowcase graphic, and two wheeled molded OCE-2 storage cases
- Lifetime hardware warranty against manufacturer defects

dimensions:

Hardware

Assembled unit:
229.585" w x 136" h x 96" d at bottom - 36" d at top
5831mm(w) x 3453mm(h) x 2438mm(d) at bottom - 914mm(d) at top
Approximate weight (includes graphic):
88.12 lbs / 40 kg

Shipping

Shipping dimensions:
2 OCE-2 cases: 18" l x 18" w x 40" h up to 66" h
457mm(l) x 457mm(w) x 1016mm(h) up to 1675mm(h)
Approximate shipping weight (with cases):
130 lbs / 59 kg

Graphic

Refer to related graphic template for more information.

Visit:
www.exhibitors-handbook.com/graphic-templates

additional information:

Graphic material:
Dye-sublimated zipper pillowcase fabric

2 person assembly recommended:



We are continually improving and modifying our product range and reserve the right to vary the specifications without prior notice. All dimensions and weights quoted are approximate and we accept no responsibility for variance. E&OE. See Graphic Templates for graphic bleed specifications.

Included In Your Kit

Tools, Components, & Connectors



ARCH-03-T8 x2



ARCH-03-T1 x4

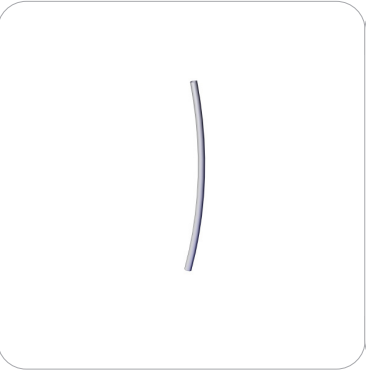

ARCH-03-T2 x8



ARCH-03-T3 x2



ARCH-03-T4 x2

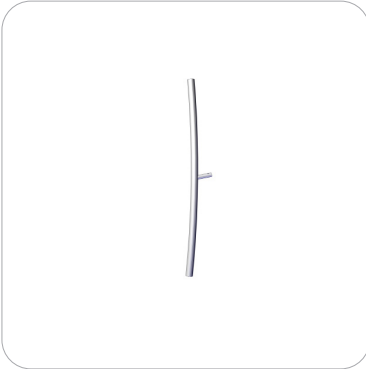

ARCH-03-T5 x1



ARCH-03-T6 x1

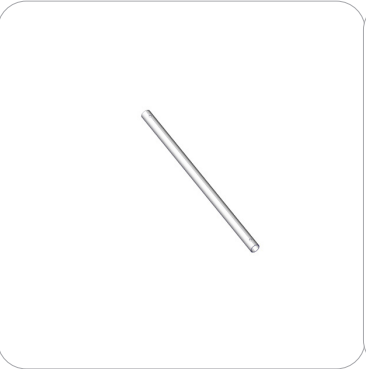

ARCH-03-T7 x1



ES30 x6



ES50 x18

Graphics



ARCH-03-G x1

Exploded View

ARCH-03

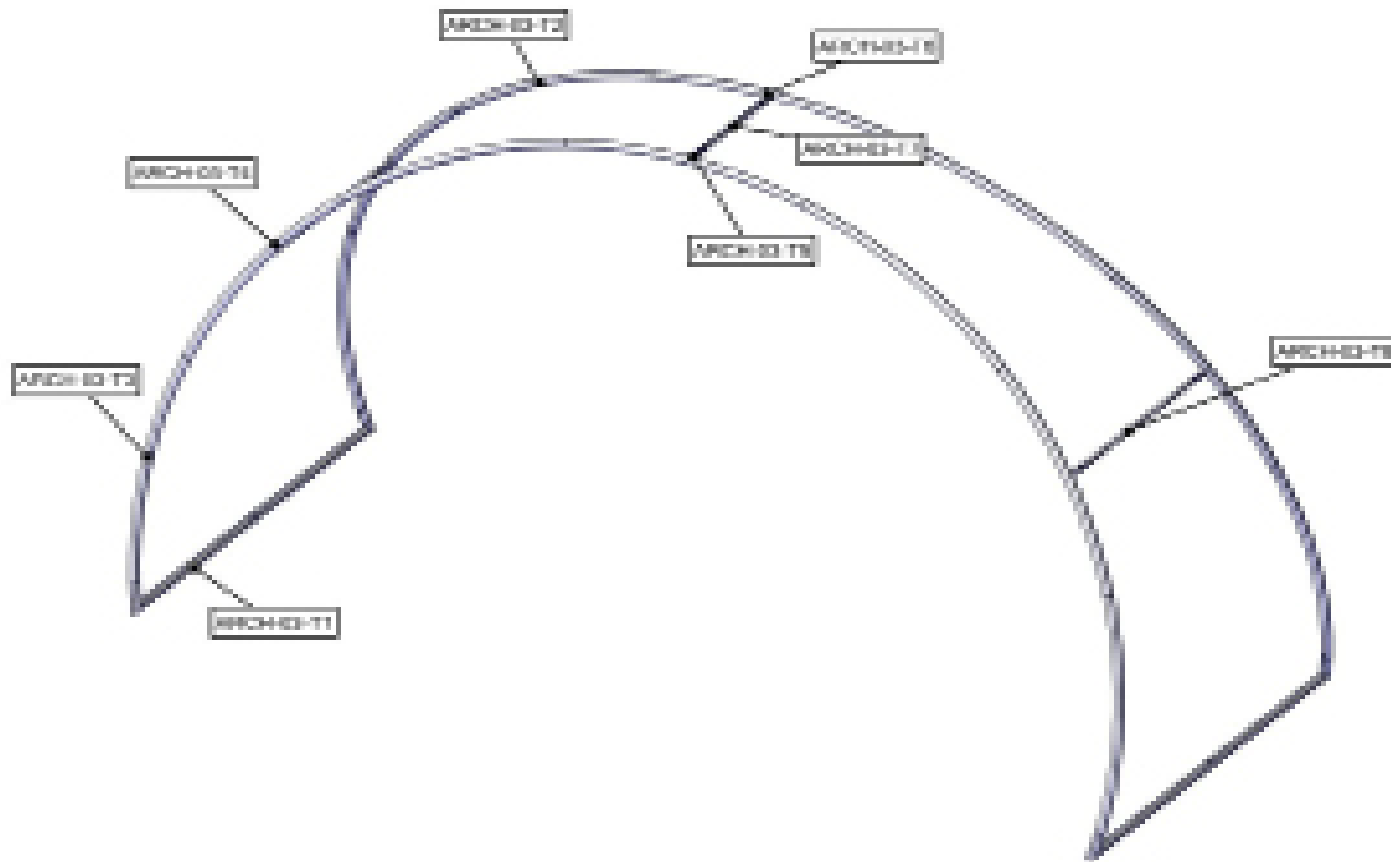

LABELING DIAGRAM

ARCH-03

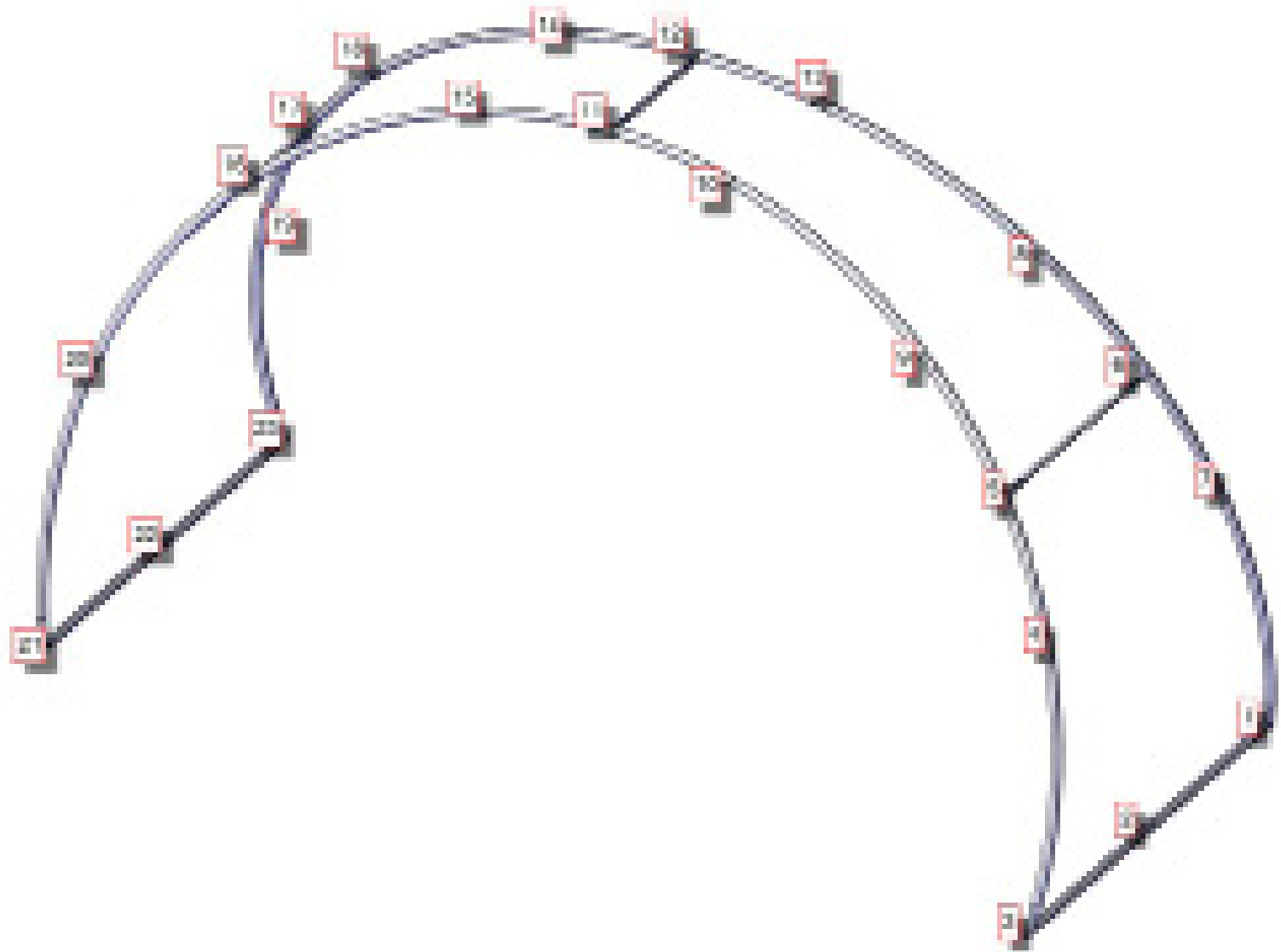

Kit Assembly

Step by Step

Step 1.

Gather the components to build the ARCH-03. Use the Exploded View and the Labeling Diagram for part labels.

Reference Connection Method(s) 1 and 2 for more details.

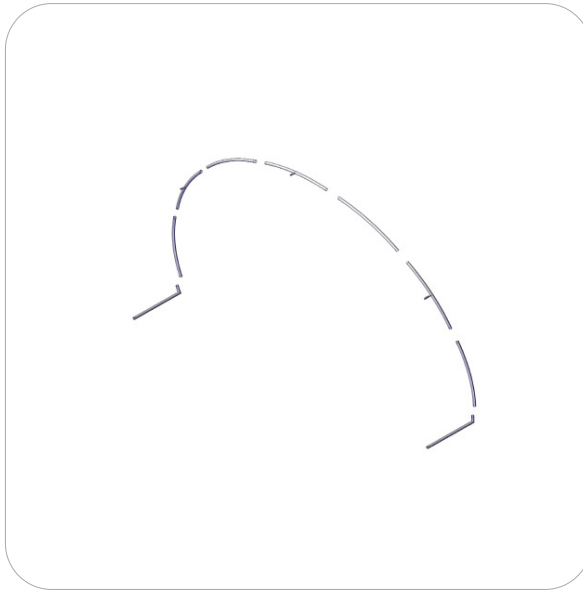
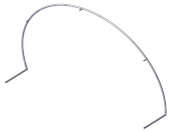

Step 2.

Gather the components to build the ARCH-03. Use the Exploded View and the Labeling Diagram for part labels.

Reference Connection Method(s) 1 and 2 for more details.

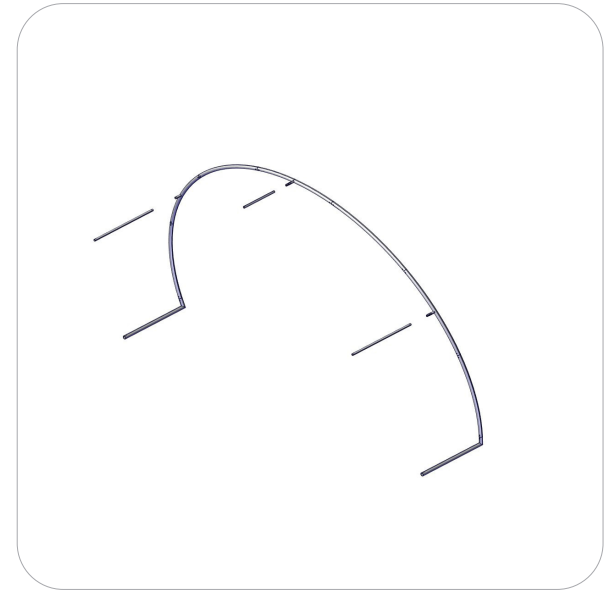
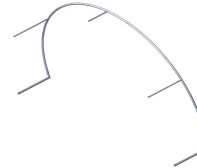

Step 3.

Gather the components to build the ARCH-03. Use the Exploded View and the Labeling Diagram for part labels.

Reference Connection Method(s) 1 and 2 for more details.

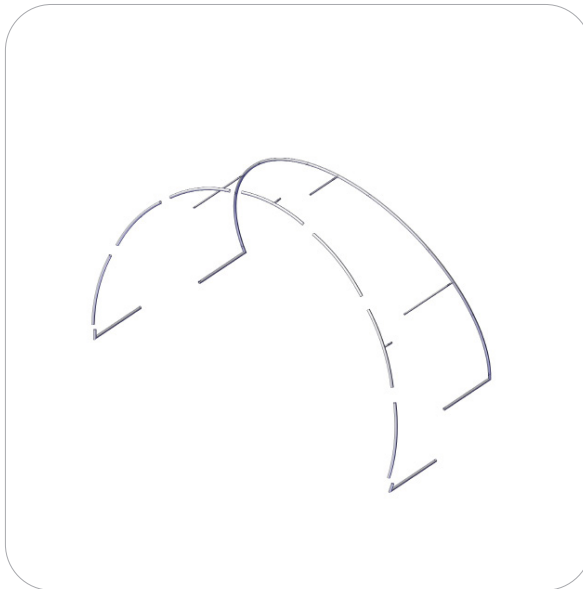
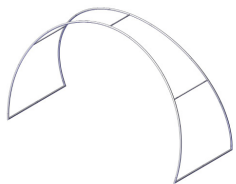

Step 4.

With the assistance of another, pull graphic over frame, being careful not to snag or tear graphic. Once pulled tightly, you may zip closed.

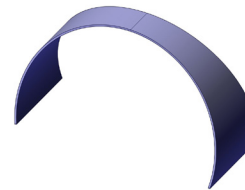

Setup is complete.



Connection Methods

Connection Method 1: ES30

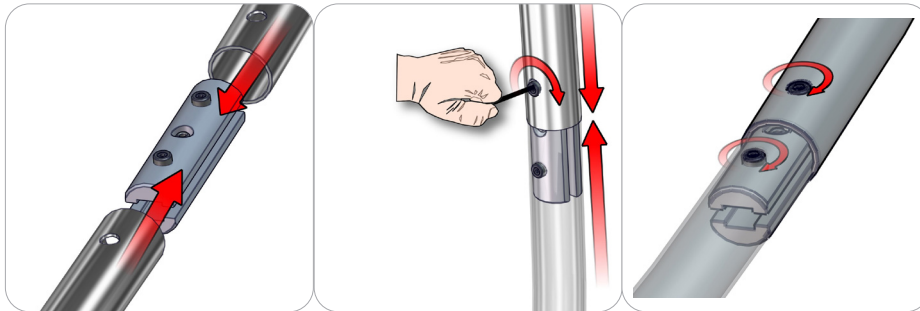

For spigot connections for ES30, compress the unlocked connector and slide into the tube lock access hole. Lock both screws carefully using your allen key tool. Be sure to lock securely, but do not over tighten. Do not force the connection and be careful with the tube edges, they may be sharp. To disassemble, unlocked connector press the snap button and pull apart.

Connection Method 2: ES50

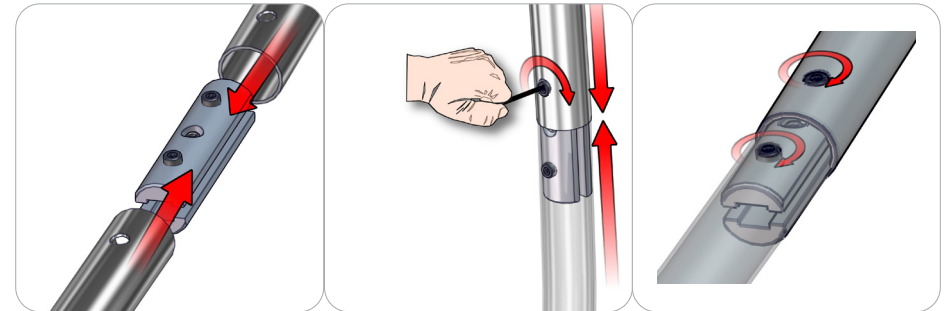

For spigot connections ES50, compress the unlocked connector and slide into the tube lock access hole. Lock both screws carefully using your allen key tool. Be sure to lock securely, but do not over tighten. Do not force the connection and be careful with the tube edges, they may be sharp. To disassemble, unlocked connector press the snap button and pull apart.