

# Universal Light Clamp Kit

UNI-LT-CLP30

UNI-LT-CLP50

Lighting can create a powerful, impactful presence or display. Illumination is an important piece of the puzzle to achieve the mood, style and staging that you desire. A variety of Luminosity™ display lights, lighting kits and solutions are available to help your clients make their projects shine!



## features and benefits:

- Allows our lights to fit a majority of banners, truss and panels.
- Works with Lumina 1, 2, 5, 6, 8, the Lumina 200 Floodlight, and the Lumina 200 LED
- Works with the LED flood, spot, and strip
- Easy to attach to almost any system
- Dual dove tail design for top or side mounting options
- Kit includes one screw driver, one universal clamp, one Coyote™ popup fitting, and one universal fitting
- Lifetime hardware warranty against manufacturer defects
- Easy to store and adjust to fit for size

## dimensions:

### Hardware

Assembled unit:  
3.5" w x 2.25" h x 1.47" d  
89mm(w) x 58mm(h) x 38mm(d)

Approximate weight:  
1 lbs / 1 kgs

### Shipping

Shipping Dimensions:  
6" l x 4" h x 4" d  
152mm(l) x 102mm(h) x 102mm(d)

Approximate total shipping weight:  
UNI-LT-CLP30 : 1 lbs / 1 kgs  
UNI-LT-CLP50 : 1 lbs / 1 kgs

## additional information:



Open: 1.5" [38mm] Closed: .25" [6.35mm]



Open: 2.75" [70mm] Closed: .25" [6.35mm]

1 person assembly recommended:



We are continually improving and modifying our product range and reserve the right to vary the specifications without prior notice. All dimensions and weights quoted are approximate and we accept no responsibility for variance. E&OE. See Graphic Templates for graphic bleed specifications.

# Kit Assembly

## Step by Step

### Step 1.

First, slide your Luminosity light stem onto the desired dove tail of the clamp. Then, loosen the clamp thumb screw turning it counter clock-wise.



### Step 2.

Place the clamp on the post and hold it there while tightening.

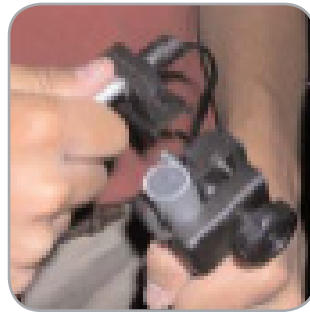

### Step 3.

Hold the light in place while you secure it to the pole.



### Step 4.

Use the screwdriver to loosen or tighten the joint so that you can adjust the position of the light.

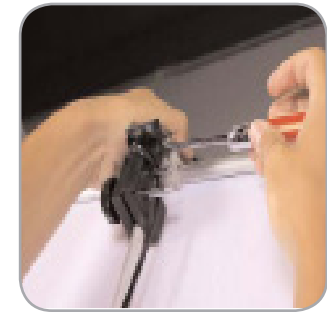

### Step 5.

The finished light should look like this.



### Step 6.

Mount your light with the knob facing the back.



### Step 7.

The light can also be mounted on a truss.

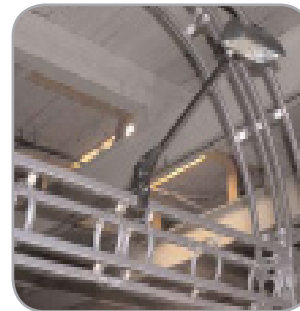

### Step 8.

Another way to mount your light is on a popup. For this you need the popup light clip.



# Kit Assembly

## Step by Step

### Step 9.

Slide the clip onto the light with the clip hanging off the back of the light.



### Step 10.

Slide the light with the clip on the right side between one of the cross sections of the Coyote.



### Step 11.

Make sure that the light is under the back pole and over the front pole of the coyote fitting.



### Step 12.

This is what the end result should look like.



### Step 13.

The light can also be mounted on the top of the Coyote using one of the hubs.

