

10' EuroFit Gateway with Runner

Product Parts (not to scale)

1) Main Frame Pieces:

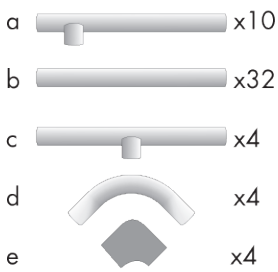

2) 4-piece Shock-corded Poles for Runner Graphic

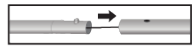

3) Gateway Graphic



4) Runner Graphic

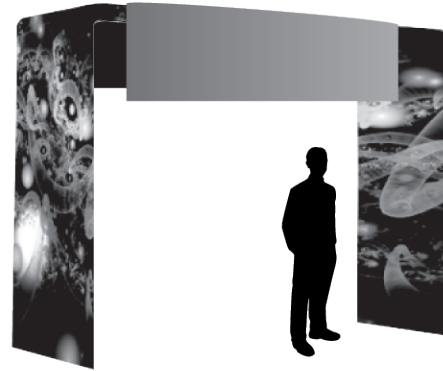

Display Set-Up

Step 1

Clear a clean area large enough to assemble the display on its side. Begin connecting the Main Frame Pieces (1a-e) according to their matching numbers and shapes.

The numbers match directly and the shapes are color-coded, where the solid shapes line up with their outlined versions, shown here:



Step 2

Once the frame is complete, unzip the Gateway Graphic (3) and drape it over the frame. Zip the graphic shut around the frame.

Step 4

With the poles inside its pockets, lay the Runner Graphic (4) across what will be the top of the Gateway, so that it will hang evenly once the display is upright. It's recommend that the Runner Graphic be adjusted before standing the display upright.

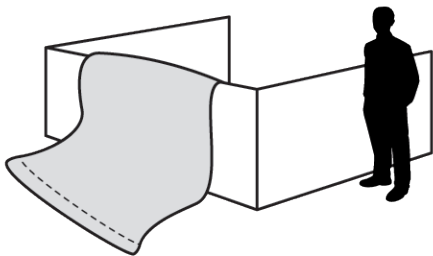

Step 3

Unfold the 4-piece Shock-corded Poles (2) and using the push buttons, construct the full poles. Insert the poles into the Runner Graphic's (4) pockets.

Step 5

With two people, carefully lift the Display upright.



Storage & Care

Wipe the frame with damp cloth to clean. Machine wash either graphic on a cold, gentle cycle. Only air-dry and never dry clean. Steam clean for wrinkles and store parts in a cool, dry place. If any bolts on the frame need to be tightened, use a 5mm Hex Wrench (not included).